

Novatech®



300 SERIES | ALL PVC - LOW MAINTENANCE

FROM PATIO DOOR TO ENTRANCE DOOR

CHOOSE...



301

**Absolute refinement.
A sure value.**

Welded PVC frame

Welded PVC panels

- Recommended for renovation and new construction, residential projects: single family, condos or multi-units.
- Excellent quality and performance.
- Structural transoms and sidelites minimize air & water infiltration.
- Thermally welded frame & panels.
- Maintenance free, all PVC construction with integrated nail fin and easy installation.
- Large glass area and minimal frames in your view.
- Sizes up to 16' x 8' (W x H).
- Tandem wheels for easy and smooth operation.
- Integrated white or satin grey blinds with Low E glass, available.
- Triple glazing available up to 16' x 8' (W x H).



310

**Hurricane protection with maximum
light and contemporary look.**

Welded PVC frame

Welded PVC panels

- The ideal door to protect you from hurricanes. Tested to resist the worst weather conditions.
- 1" thick impact rated, insulated laminated glass units.
- Maintenance free, PVC construction and stainless steel hardware.
- Tandem wheels for easy and smooth operation.



370

The wide sashes evoke the charm of a garden door.

Welded PVC frame

Mechanically assembled PVC panels

- The 370 combines the practicality of a sliding door with the look of a garden door. Arrange your furniture as you wish with no interference inside or out!
- Excellent quality and performance.
- Structural transoms and sidelites minimize air & water infiltration.
- Thermally welded frame with direct set fixed panel.
- A direct set fixed panel keeps the door square when assembled.
- Maintenance free, all PVC construction with integrated nail fin and easy installation.
- Large glass area and minimal frames in your view.
- Sizes up to 16' x 8' (W x H).
- Tandem wheels for easy and smooth operation.
- Integrated white or satin grey blinds with Low E glass, available.
- Triple glazing available up to 16' x 8' (W x H).

WARRANTY

20 YEAR LIMITED WARRANTY ON UNPAINTED PVC
AND WHITE ALUMINUM EXTRUSION

20 YEAR LIMITED WARRANTY ON LOW-E GLASS UNIT
(RESIDENTIAL APPLICATION)

10 YEAR LIMITED WARRANTY ON INTEGRATED BLINDS

5 YEAR LIMITED WARRANTY ON HARDWARE

WARRANTY CERTIFICATE AVAILABLE UPON REQUEST

All products come standard with tempered glass and non-conductive spacer

4

4 5/8" PVC frame
(3 1/4" behind the
integrated nailing fin)

Narrow welded PVC sash with
steel reinforced vertical stiles
and glazing stops

Standard "Prestige" mortise handle

Insulated glass unit with
tempered glass and
non-conductive spacer

Tandem bearings with
frontal wheel adjustment

Welded PVC brick mould
with anodized aluminum sill
extension and integrated
nailing fin

Aluminum
sill cover
(optional)

Anodized aluminum
screen rail

Drainage system with
anti-return flap (water and air)



CHOICE OF OPENINGS AND SIZES *Exterior view

X= OPERATING PANEL
O= FIXED PANEL

5'	6'	8'	9' & 12'	9' & 12'	10', 12' & 16'
<div> <div>O</div> <div>X</div> <div>X</div> <div>O</div> </div>	<div> <div>O</div> <div>X</div> <div>X</div> <div>O</div> </div>	<div> <div>O</div> <div>X</div> <div>X</div> <div>O</div> </div>	<div> <div>O</div> <div>X</div> <div>O</div> <div>X</div> <div>O</div> <div>O</div> <div>X</div> </div>	<div> <div>X</div> <div>O</div> <div>X</div> </div>	<div> <div>O</div> <div>X</div> <div>X</div> <div>O</div> </div>
59 1/2" x 79 1/2" or 95 1/2"	71 1/2" x 79 1/2" or 95 1/2"	95 1/2" x 79 1/2" or 95 1/2"	107" x 79 1/2" or 95 1/2" 143" x 79 1/2" or 95 1/2"	107 1/2" x 79 1/2" or 95 1/2" 143 1/2" x 79 1/2" or 95 1/2"	116 1/2" x 79 1/2" or 95 1/2" 140 5/8" x 79 1/2" or 95 1/2" 188 11/16" x 79 1/2" ou 95 1/2"

ABSOLUTE REFINEMENT. A SURE VALUE
WELDED PVC FRAME | WELDED PVC PANELS

301

5

ALSO AVAILABLE :
INTEGRATED ALUMINUM MINI-BLINDS
OPTIONS – SATIN GREY



PERFORMANCES

Harmonized Standards - 96" x 80"	Air-tightness	Water-tightness	Structure	Overall
AAMA/WDMA/CSA101/I.S.2/A440-08	PASSED	360 Pa (470 Pa)	DP-50	PG-R50
Energy efficiency		FL product approval		
Double Glazed, Low-E 366 face #2 U 0.29 / SHGC 0.22		FL27628.1 to FL27628.10		
Double Glazed, Low-E 272 face #2 U 0.29 / SHGC 0.34				
Triple Glazed, Low-E 366 face #2 U 0.24 / SHGC 0.21				
Triple Glazed, Low-E 366 face #5 U 0.23 / SHGC 0.31				
Triple Glazed, Low-E 366 face #2 & #5 U 0.19 / SHGC 0.20				

* ACOUSTIC: STC34 (optional) | Testing performed in a laboratory

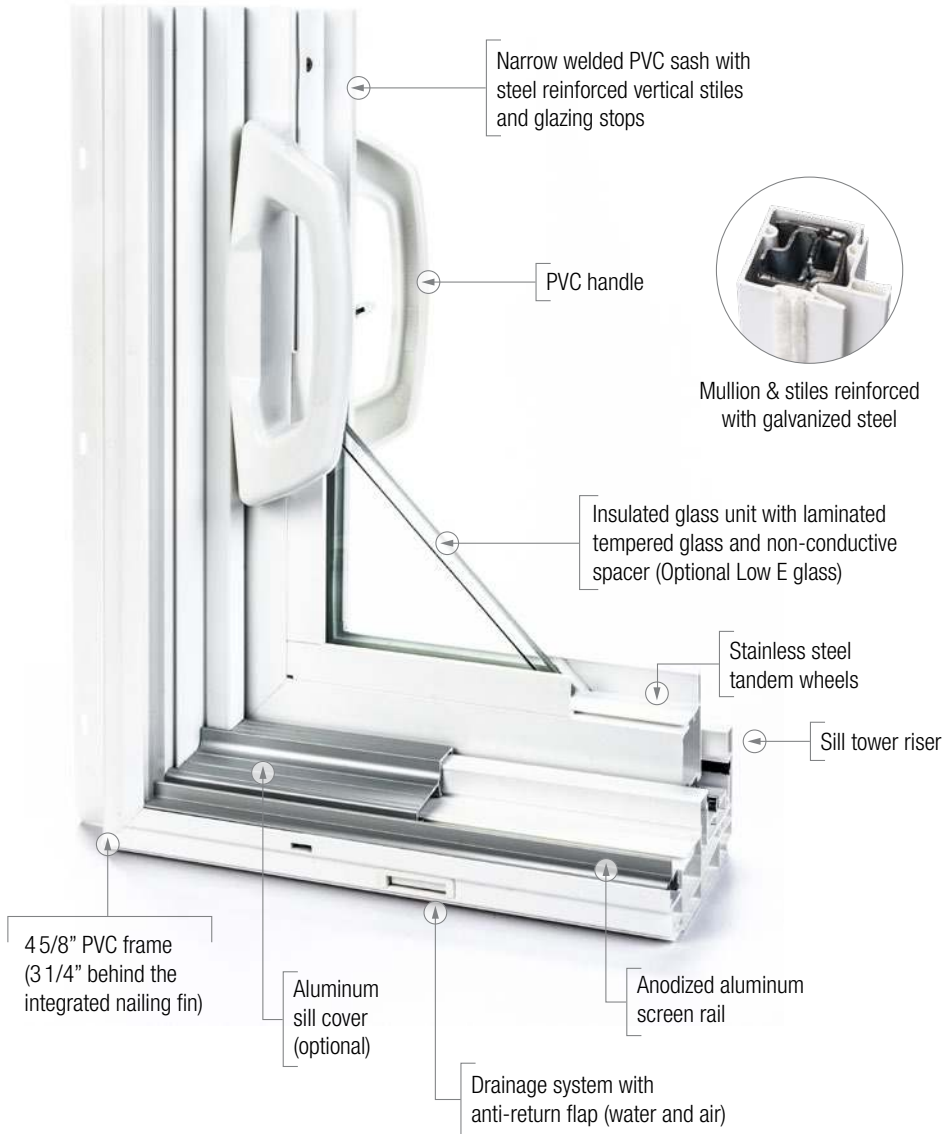

CHOICE OF OPENINGS AND SIZES *Exterior view

X= OPERATING PANEL
O= FIXED PANEL

5'	6'	8'	9'	12'
<div> <div>O</div> <div>X</div> <div>X</div> <div>O</div> </div>	<div> <div>O</div> <div>X</div> <div>X</div> <div>O</div> </div>	<div> <div>O</div> <div>X</div> <div>X</div> <div>O</div> </div>	<div> <div>O</div> <div>X</div> <div>O</div> </div>	<div> <div>O</div> <div>X</div> <div>O</div> </div>
59 1/2" x 79 1/2" or 95 1/2"	71 1/2" x 79 1/2" or 95 1/2"	95 1/2" x 79 1/2" or 95 1/2"	107" x 79 1/2" or 95 1/2"	143" x 79 1/2" or 95 1/2"

HURRICANE PROTECTION WITH MAXIMUM LIGHT AND CONTEMPORARY LOOK
WELDED PVC FRAME | WELDED PVC PANELS

310

7



SHOWN WITH BLACK PAINT (OPTIONAL)

PERFORMANCES

DP-50; Wind Zone 4; IMPACT rated; please contact us for more details	FL product approval
Harmonized standards - 96" x 96" AAMA/WDMA/CSA101/I.S.2/A440-05 / ASTM E1886-05	FL27628.11 to FL27628.12

Testing performed in a laboratory

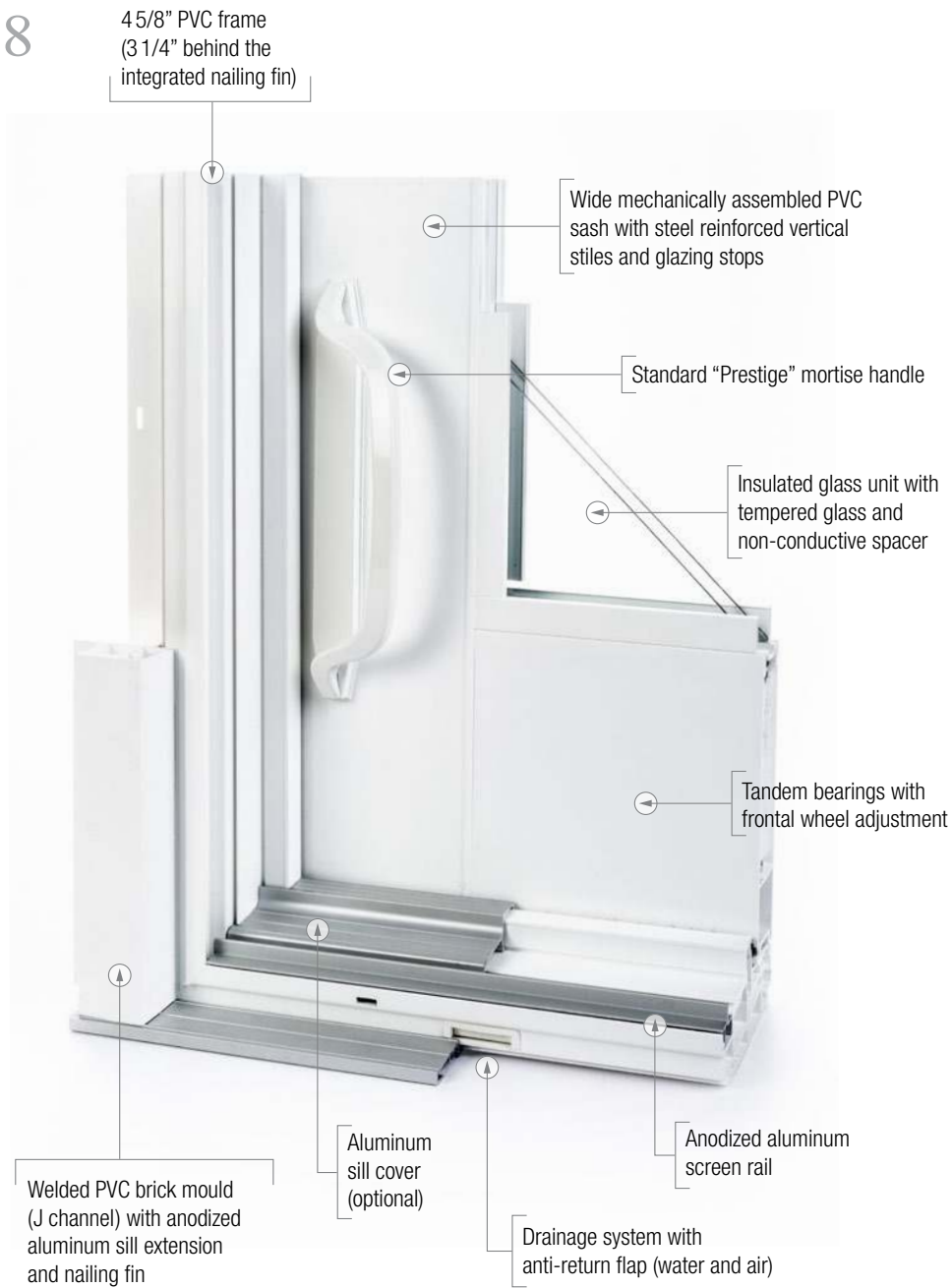

CHOICE OF OPENINGS AND SIZES *Exterior view

X= OPERATING PANEL
O= FIXED PANEL

5'	6'	8'	9' & 12'	9' & 12'	10', 12' & 16'																												
<table><tr><td>0</td><td>X</td></tr><tr><td>X</td><td>0</td></tr></table>	0	X	X	0	<table><tr><td>0</td><td>X</td></tr><tr><td>X</td><td>0</td></tr></table>	0	X	X	0	<table><tr><td>0</td><td>X</td></tr><tr><td>X</td><td>0</td></tr></table>	0	X	X	0	<table><tr><td>0</td><td>X</td><td>0</td></tr><tr><td>X</td><td>0</td><td>0</td></tr><tr><td>0</td><td>0</td><td>X</td></tr></table>	0	X	0	X	0	0	0	0	X	<table><tr><td>X</td><td>0</td><td>X</td></tr></table>	X	0	X	<table><tr><td>0</td><td>X</td><td>X</td><td>0</td></tr></table>	0	X	X	0
0	X																																
X	0																																
0	X																																
X	0																																
0	X																																
X	0																																
0	X	0																															
X	0	0																															
0	0	X																															
X	0	X																															
0	X	X	0																														
59 3/8" x 79 1/2" or 95 1/2"	71 3/8" x 79 1/2" or 95 1/2"	95 3/8" x 79 1/2" or 95 1/2"	107 1/2" x 79 1/2" or 95 1/2" 143 1/2" x 79 1/2" or 95 1/2"	107 1/2" x 79 1/2" or 95 1/2" 139 5/8" x 79 1/2" or 95 1/2"	116 3/4" x 79 1/2" or 95 1/2" 140 3/4" x 79 1/2" or 95 1/2" 188 13/16" x 79 1/2" ou 95 1/2"																												

THE WIDE SASH EVOKES THE CHARM OF A GARDEN DOOR

WELDED PVC FRAME | MECHANICALLY ASSEMBLED PVC PANELS

370

9



ALSO AVAILABLE :
INTEGRATED ALUMINUM MINI-BLINDS
OPTIONS – SATIN GREY

PERFORMANCES

Harmonized Standards - 96" x 80"	Air-tightness	Water-tightness	Structure	Overall
AAMA/WDMA/CSA101/I.S.2/A440-08	PASSED	360 Pa	DP-50	PG-R50

Energy efficiency

Double Glazed, Low-E 366 face #2	U 0.31 / SHGC 0.18
Double Glazed, Low-E 272 face #2	U 0.31 / SHGC 0.27
Triple Glazed, Low-E 366 face #2	U 0.26 / SHGC 0.17
Triple Glazed, Low-E 366 face #5	U 0.26 / SHGC 0.25
Triple Glazed, Low-E 366 face #2 & #5	U 0.23 / SHGC 0.16

Testing performed in a laboratory

OPTIONS

OFFERED DEPENDING ON THEIR
AVAILABILITY FOR EACH MODEL

GLASS

10

Integrated aluminum mini-blinds with Low E glass

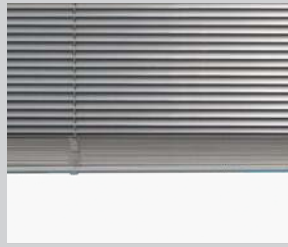

White or Satin grey
Available only in 79 1/2" height



TRANSOMS AND SIDELITES

N/A 310

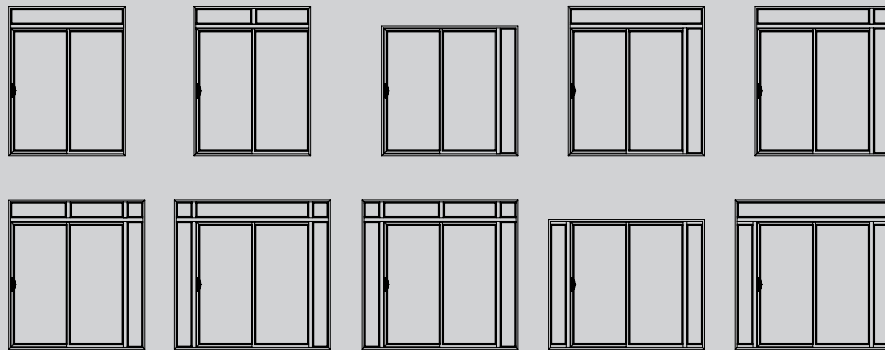

GRIDS

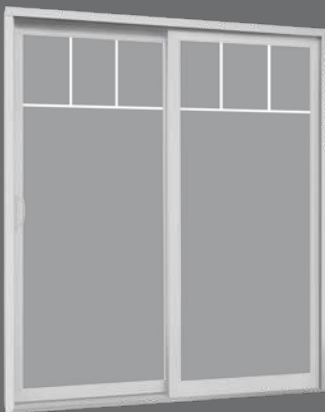

Hanging grids
3 x 1

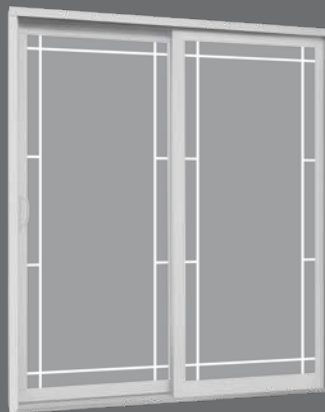

Perimeter / Prairie grids
3 x 5



Regular grids
3 x 5 or 3 x 6

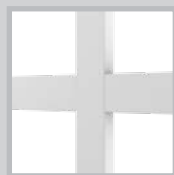

Rectangular / Flat 5/8" or 1"



Georgian / Contoured 5/8" or 1"

OPTIONS CHART

	301	310	370
Transoms	•	—	•
Sidelites	•	—	•
Paint	•	•	•
Low E glass	STD	STD	STD
Triple glass	•	—	•
Tinted grey or bronze glass	•	•	•
Integrated blinds with Low E glass - White	•	—	•
Integrated blinds with Low E glass - Satin Grey	•	—	•
Grids	•	—	•
Brick mould and sill extension	•	•	•
Sill extension	•	•	•
Nail fin	•	•	•
Security bar	•	•	•
Head lock	—	—	•
Foot lock	•	—	•
Double-point mortise lock	•	STD	STD
Signature handle	•	—	•
Keyed lock	•	•	•
Ultra-resistant screen	•	•	•

COLORS

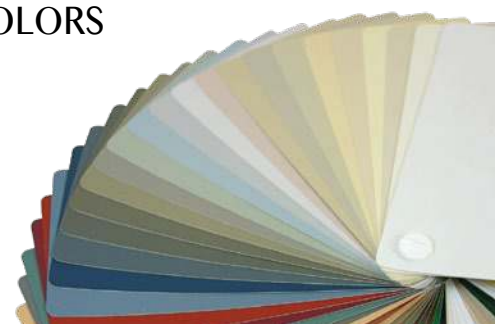

11

HANDLES

**STANDARD
PRESTIGE**



**OPTION:
Double-point
mortise**

**OPTION
SIGNATURE**



Brass, antique brass, oil rubbed bronze,
brushed chrome and
brushed antique pewter

Signature™
SERIES
TRUTH
HARDWARE

PVC BRICK MOULD

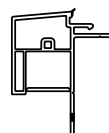

1 1/2"

Please contact your retailer for the availability of these options. Custom configuration possibilities.



Flush steel door with integrated aluminum mini-blinds - Satin grey

970-0357 (Patio door brochure 300 Series) (05/2019)

Novatech®

novatechgroup.com

DISTRIBUTED BY

ALBERTA

5505, 72nd Avenue SE, Unit 17
Calgary T2C 3C4

EUROPE

8 quai du Canal, BP83
42 302 Roanne

ONTARIO

2070 Codlin Crescent, Unit 1
Toronto M9W 7J2

QUÉBEC

160 Murano Street
Sainte-Julie J3E 0C6 | 100, 181st Street
Beauveville G5X 2T1

USA

180 Textile Drive,
Ridgeway, Virginia, 24148

